



# SD73 SMD Power Inductor



## Features:

- Low Profile 3.8 mm Max. height.
- Inductance range 0.3 $\mu$ H ~ 470  $\mu$ H.
- 1000 pcs per reel.

| Mechanical Dimmensions (Unit: mm) |           |           |           |      |           |
|-----------------------------------|-----------|-----------|-----------|------|-----------|
| Part Number                       | A         | B         | C         | D    | E         |
| SD73                              | $\pm 0.3$ | $\pm 0.3$ | $\pm 0.3$ | Ref. | $\pm 0.5$ |
| SD73                              | 7.0       | 7.8       | 3.5       | 3.0  | 8.0       |

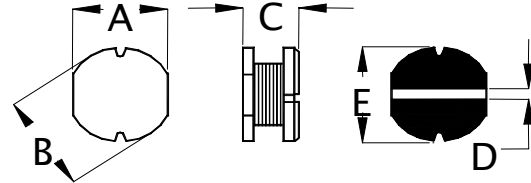

| Electrical Specifications |                        |                       |                        |                        |
|---------------------------|------------------------|-----------------------|------------------------|------------------------|
| Part Number               | L @ 100 kHz ( $\mu$ H) | DCR Max. ( $\Omega$ ) | I <sub>sat</sub> (Amp) | I <sub>rms</sub> (Amp) |
| SD73-R30U                 | 0.3+40% -20%           | 0.0045                | 13.50                  | 8.00                   |
| SD73-R60MU                | 0.6 $\pm$ 20%          | 0.006                 | 8.40                   | 8.60                   |
| SD73-R80MU                | 0.8 $\pm$ 20%          | 0.015                 | 10.62                  | 6.66                   |
| SD73-1R0U                 | 1.0 +40% -20%          | 0.010                 | 8.10                   | 6.72                   |
| SD73-1R5MU                | 1.5 $\pm$ 20%          | 0.015                 | 6.12                   | 5.08                   |
| SD73-2R2MU                | 2.2 $\pm$ 20%          | 0.020                 | 5.22                   | 4.33                   |
| SD73-2R7MU                | 2.7 $\pm$ 20%          | 0.022                 | 4.32                   | 3.58                   |
| SD73-3R3MU                | 3.3 $\pm$ 20%          | 0.025                 | 4.10                   | 3.40                   |
| SD73-4R7MU                | 4.7 $\pm$ 20%          | 0.030                 | 3.20                   | 2.66                   |
| SD73-6R8MU                | 6.8 $\pm$ 20%          | 0.050                 | 2.75                   | 2.28                   |
| SD73-8R2MU                | 8.2 $\pm$ 20%          | 0.070                 | 2.34                   | 2.16                   |
| SD73-100MU                | 10.0 $\pm$ 20%         | 0.0803                | 1.89                   | 1.99                   |
| SD73-120MU                | 12.0 $\pm$ 20%         | 0.0897                | 1.71                   | 1.80                   |
| SD73-150LU                | 15.0 $\pm$ 15%         | 0.104                 | 1.53                   | 1.61                   |
| SD73-180LU                | 18.0 $\pm$ 15%         | 0.111                 | 1.49                   | 1.56                   |
| SD73-220LU                | 22.0 $\pm$ 15%         | 0.129                 | 1.26                   | 1.32                   |
| SD73-270LU                | 27.0 $\pm$ 15%         | 0.153                 | 1.17                   | 1.23                   |
| SD73-330KU                | 33.0 $\pm$ 10%         | 0.170                 | 1.04                   | 1.09                   |
| SD73-390KU                | 39.0 $\pm$ 10%         | 0.217                 | 0.95                   | 0.99                   |
| SD73-470KU                | 47.0 $\pm$ 10%         | 0.252                 | 0.90                   | 0.95                   |
| SD73-560KU                | 56.0 $\pm$ 10%         | 0.282                 | 0.86                   | 0.90                   |
| SD73-680KU                | 68.0 $\pm$ 10%         | 0.332                 | 0.68                   | 0.71                   |
| SD73-820KU                | 82.0 $\pm$ 10%         | 0.406                 | 0.64                   | 0.67                   |
| SD73-101KU                | 100.0 $\pm$ 10%        | 0.481                 | 0.60                   | 0.63                   |
| SD73-121KU                | 120.0 $\pm$ 10%        | 0.536                 | 0.49                   | 0.52                   |
| SD73-151KU                | 150.0 $\pm$ 10%        | 0.755                 | 0.47                   | 0.49                   |
| SD73-181KU                | 180.0 $\pm$ 10%        | 1.022                 | 0.43                   | 0.45                   |
| SD73-221KU                | 220.0 $\pm$ 10%        | 1.200                 | 0.38                   | 0.40                   |
| SD73-271KU                | 270.0 $\pm$ 10%        | 1.306                 | 0.34                   | 0.36                   |
| SD73-331KU                | 330.0 $\pm$ 10%        | 1.495                 | 0.30                   | 0.31                   |
| SD73-471KU                | 470.0 $\pm$ 10%        | 2.500                 | 0.26                   | 0.27                   |

## Notes:

1. I<sub>sat</sub>: 10% inductance roll off.
2. I<sub>rms</sub>: 40 °C temperature rise.
3. Operating temperature: -25 ~130 °C.